



Activities: **Machines**

Year of foundation.....**1908**

Number of employees.....**694**

## Production

- CNC bed-type boring-milling machines;
- CNC drilling-boring-milling machines;
- Bed-type planing machines;
- Planing and milling machines;
- Bed-type grinding machines;
- Edge-banding machines;
- Slotting machines;
- Turning lathe machines;
- Nail-wire automatic machines;
- Machines for balancing;

## Contacts

220030, Republic of Belarus,  
Minsk, 16 Oktyabrskaya str.  
Tel: (+375 17) 227-59-22  
Fax: (+375 17) 227-23-73  
E-mail: [mzor@mzor.com](mailto:mzor@mzor.com)  
[www.mzor.com](http://www.mzor.com)

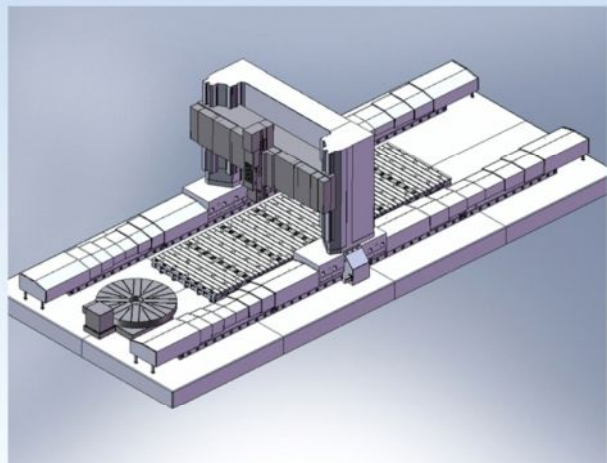

# New Line of Activity peat briquet Press MS1600-35T

## Function:

Making of different size fuel briquettes from peat, saw dust and other flammable materials and bulk solids.

## Advantages:

- Increase of efficiency by 10-20%
- Decrease of expenditure of electricity by 13%

Characteristic name, measure	Amount
Number of stamp, unit	2
Runway length of stamp, sm	35
Number of stamp runway, r/min	4...80
Press efficiency on peat briquette, no less than t/h	4,5
Force press tonnage, k N	1600
Nominal motor power of main drive, kWt	160
Press mass, approximately, tons	55

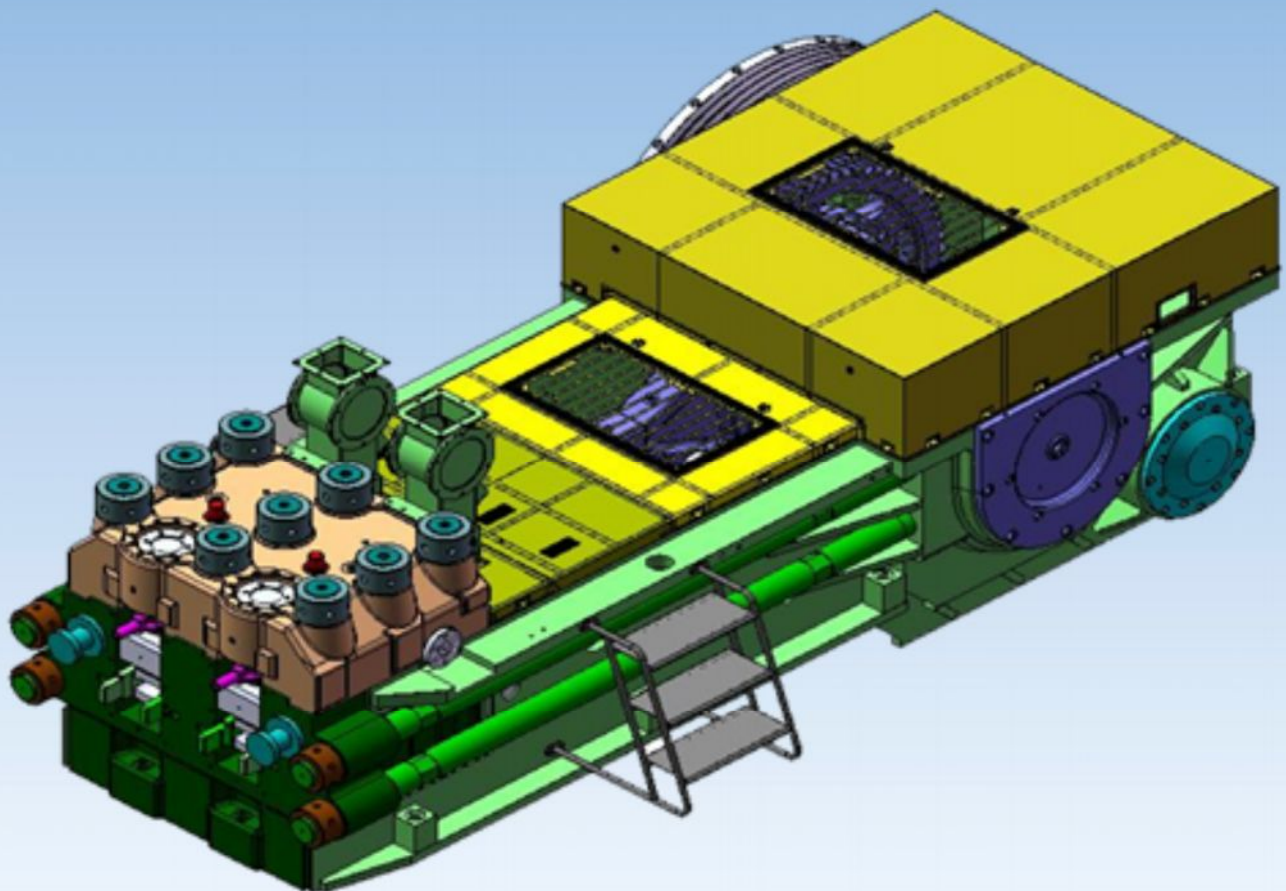

# Advanced Development Machine Model MS640GMF4-16K

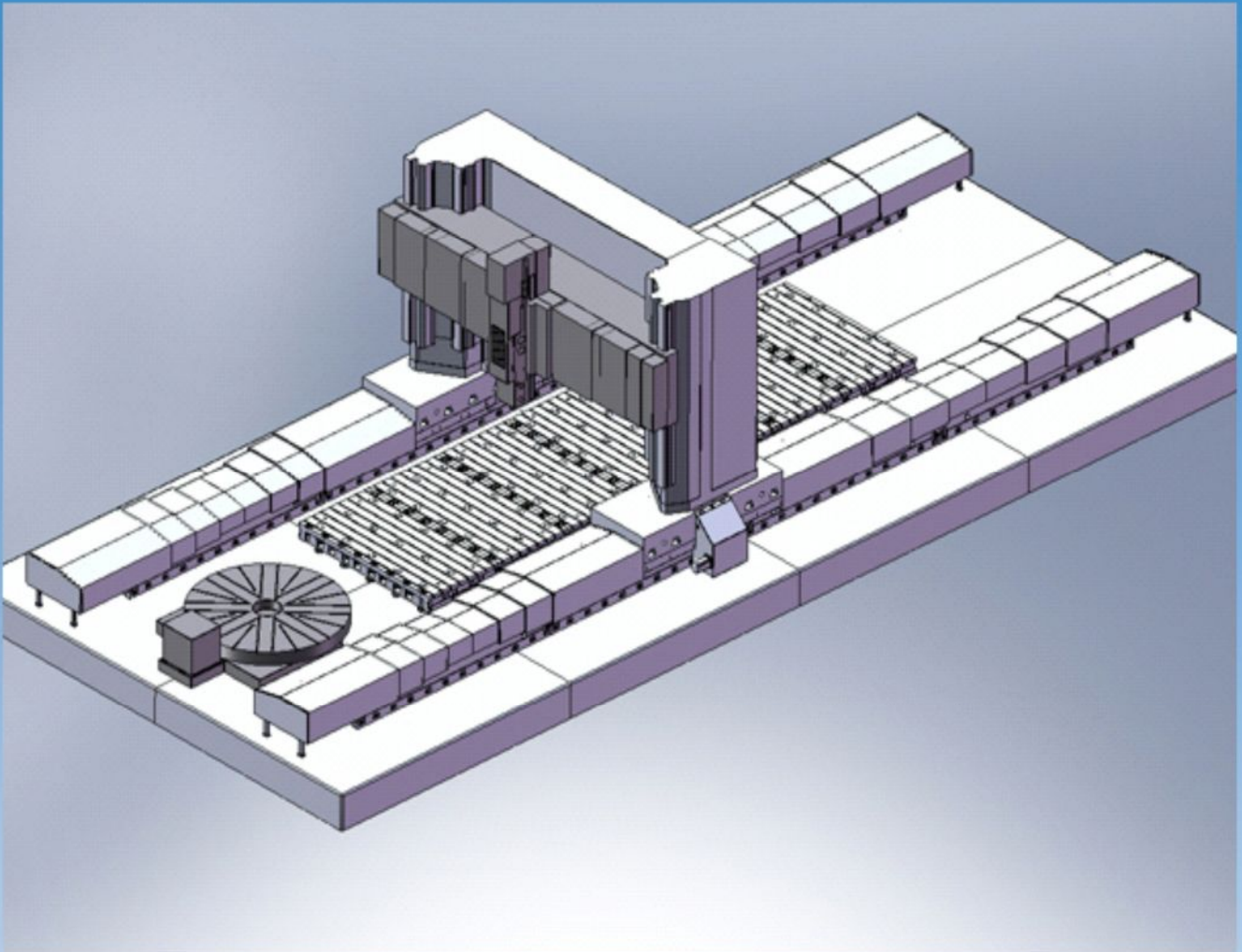

## Machine characteristics:

### Machine size:

length	24,0 m
width	9,9 m
height	8,5 m

Machine mass 350 tons

### Working table top:

width	4 m
length	16 m

Distance between column bases 5 m

### Features of machining part:

length	to 16,0 m
width	to 4,8 m
height	to 3,6 m
mass	to 250 tons



Number of Metal-Working Equipment – 300 units.

Deterioration of the Active Part of Fixed Assets  
(machines and equipment) – no more than 30%.

Duty Factor of Equipment (in 2-shift operation) – no more than 70%

### Area of investment usage

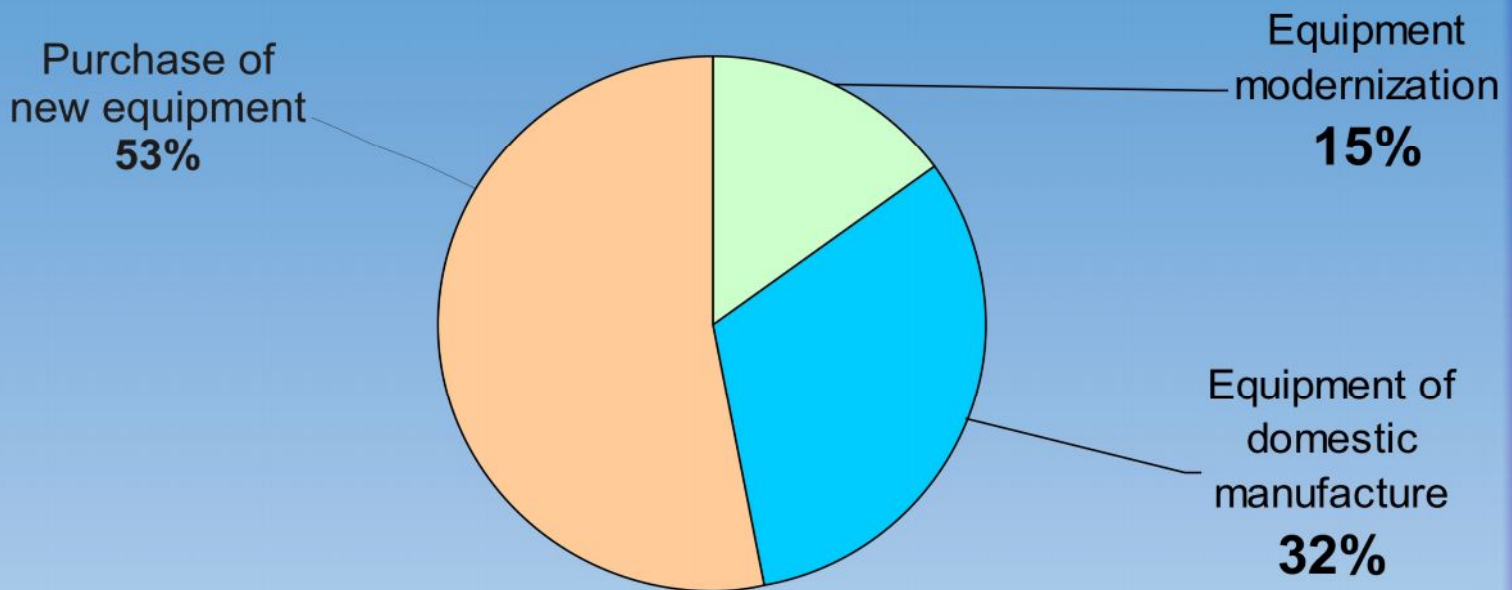

### Investment sources of finance

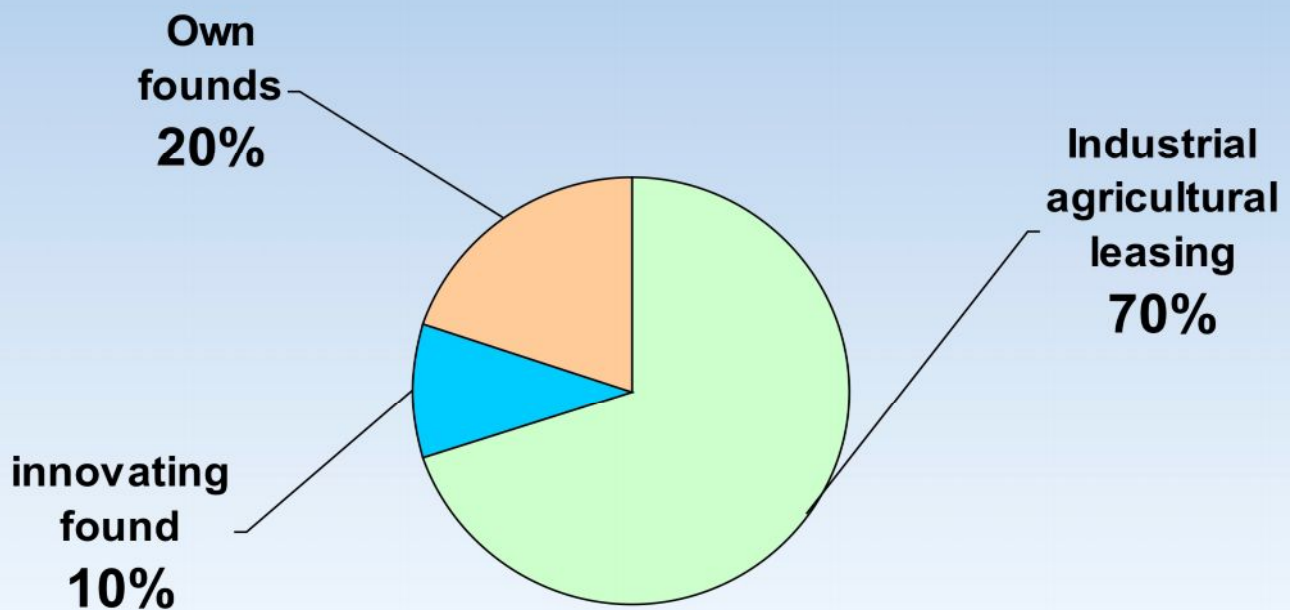

# TECHNICO-ECONOMIC MODEL OF NEW PLANT (BY 2016)

**Production volume: 25 mln \$ per year**  
*Increase by 2,0 times from 2010*

**Average wage: 1000 \$**  
*Increase by 1,8 times from 2010*

**Sale profitability: 12%**

**Investments into the basic capital:**  
*2011-2012: 14,7 mln \$*  
*2013-2014: 6,0 mln \$*

## Structure of commodity production

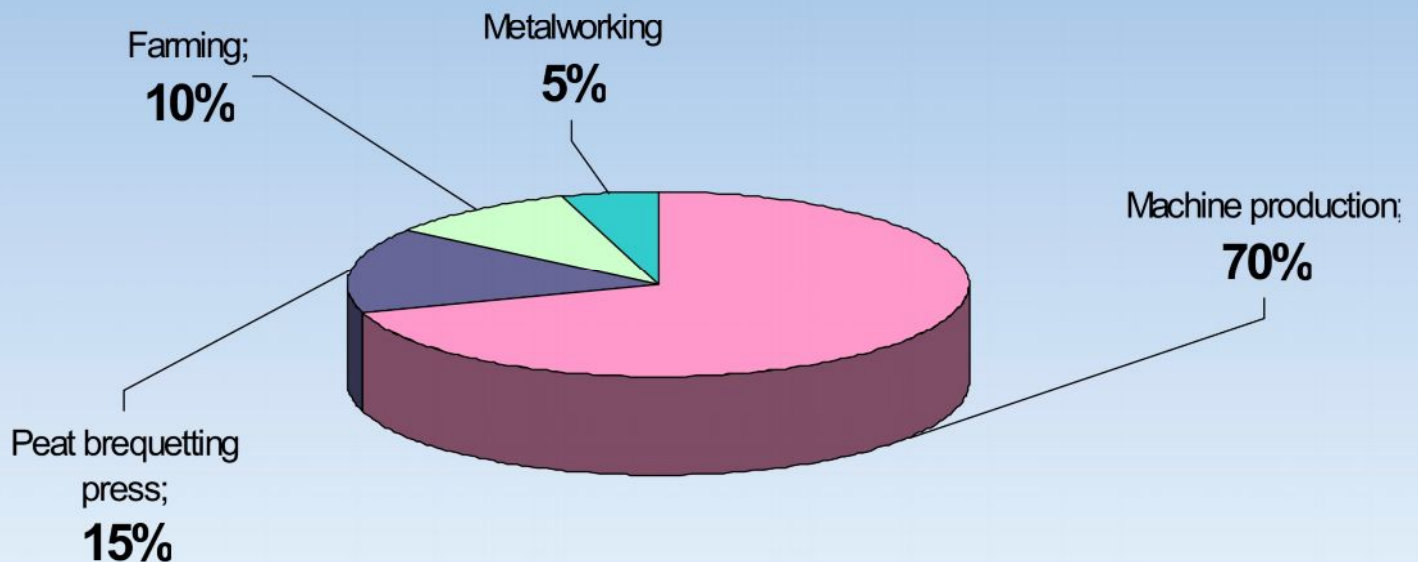

# Equipment of OJSC “MZOR” for enterprise re-equipment during 2010-2012

## MS6222PMF4

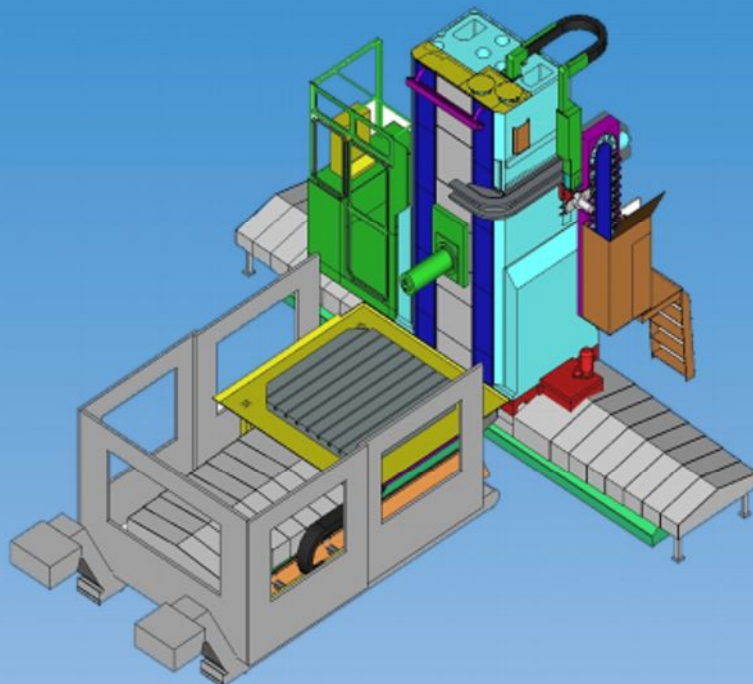

Equipment Technical Features

Feature name	Value
The greatest movement of work member, mm	
— posts on X-axis	2500
— stocks on Y-axis	2000
— guide blocks on Z-axis	700
— table longitudinally along W-axis	1500
— turn of the table on B-axis, degrees	360xn
— speed of spindle slide out, mm	750
Indication of spindle end, cone	ISO 50
Range of spindle speed, turn/min	5...3000
The greatest twisting moment on spindle, Nm	2150
Drive power of main movement, kWh	45
Overall dimension of machine without detachable equipment, mm	
— length	7950
— width	7100
— height	4600



# MSP6404MF4-04

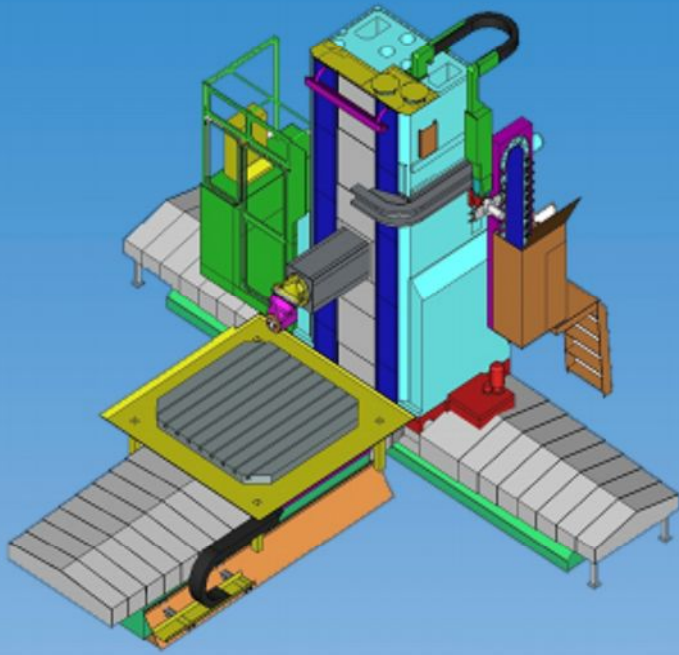

Equipment Technical Features	
Feature name	Value
The greatest movement of work member, mm	
— posts on X-axis	2500
— stocks on Y-axis	4000
— guide blocks on Z-axis	700
— table longitudinally along W-axis	1500
— turn of the table on B-axis, degrees	360xn
Indication of spindle end, cone	ISO 50
Range of spindle speed, turn/min	5...2000
The greatest twisting moment on spindle, Nm	1000
Drive power of main movement, kWh	30
Overall dimension of machine without detachable equipment, mm	
— length	7950
— width	7100
— height	6600

# MS2611MF-02

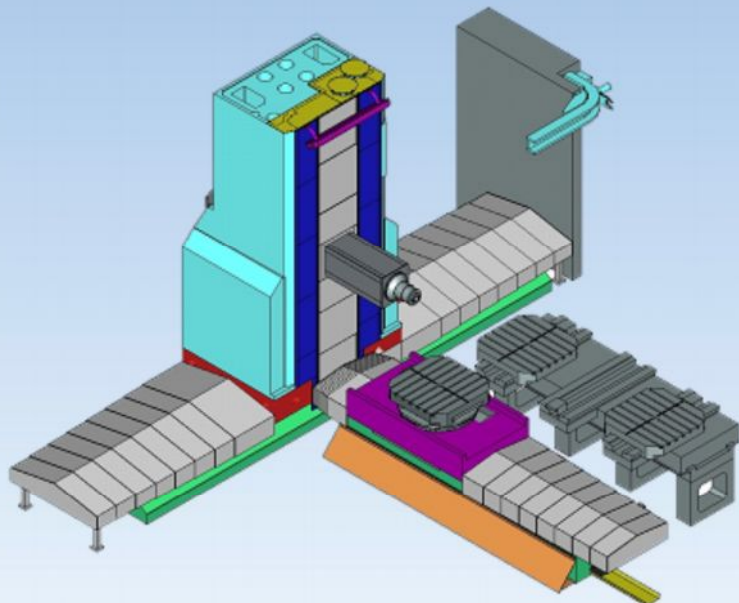

Equipment Technical Features	
Feature name	Value
The greatest movement of work member, mm	
— posts on X-axis	2500
— stocks on Y-axis	4000
— guide blocks on Z-axis	750
— table longitudinally along W-axis	1000
— turn of the table on B-axis, degrees	360xn
Indication of spindle end, cone	ISO 50
Range of spindle speed, turn/min	5...6000
The greatest twisting moment on spindle, Nm	1000
Drive power of main movement, kWh	30
Overall dimension of machine without detachable equipment, mm	
— length	7450
— width	6350
— height	3800

